



## 3 Rhodfa Parc Slip, Tondu

£240,000 Freehold

Three Bedroom Family Home • Master With Ensuite • Kitchen/Diner • Downstairs W.C • Private Rear Garden • Parking For Three Plus Cars • Sought After Location • Potential To Extend, Subject To Planning



Council Tax band: D

Tenure: Freehold

EPC Energy Efficiency Rating: B

EPC Environmental Impact Rating: B



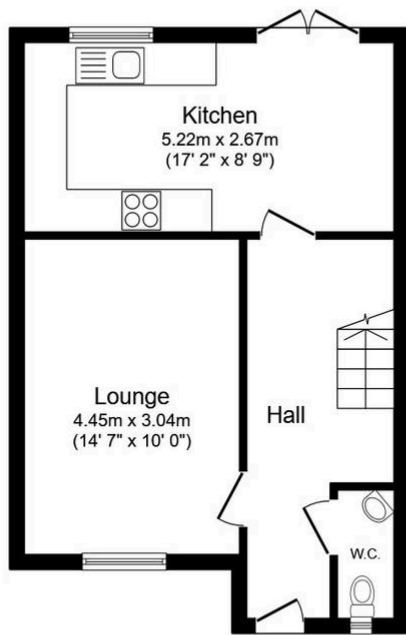

### Ground Floor

Floor area 39.6 sq.m. (426 sq.ft.)

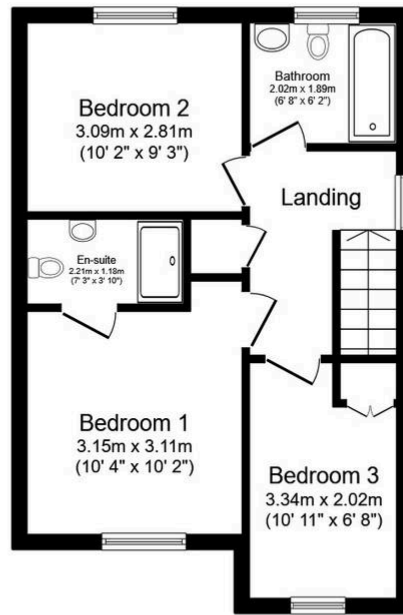

### First Floor

Floor area 39.6 sq.m. (426 sq.ft.)

Total floor area: 79.1 sq.m. (852 sq.ft.)

This floor plan is for illustrative purposes only. It is not drawn to scale. Any measurements, floor areas (including any total floor area), openings and orientations are approximate. No details are guaranteed, they cannot be relied upon for any purpose and do not form any part of any agreement. No liability is taken for any error, omission or misstatement. A party must rely upon its own inspection(s). Powered by [www.Propertybox.io](http://www.Propertybox.io)

You can include any text here. The text can be modified upon generating your brochure.